

ROOFING TYPE  
SPECIFIED: \_\_\_\_\_

15 LB. VAPOR BARRIER  
ON 1/2" O.S.B. ROOF SHEATHING

WOOD TRUSS AT 24" O.C.

FASCIA BOARD

PRESSURE TREATED BOARD IN CONTACT  
W/ CONC. WALL. ANCHOR WITH 1/2" DIA.  
BOLTS AT 48" O.C. MAX. GROUT SOLID

8" CONCRETE BLOCK WALL WITH  
HORIZONTAL REINFORCING AT 24" O.C.  
AND #4 VERTICAL REINFORCING AT 48" O.C.  
GROUT SOLID

CONTINUOUS CONCRETE FOOTING W/  
(1) #4 AT BOTTOM

1'-0"

PUT DIMENSIONS AT THE CIRCLES

CITY OF MESA - FOR REFERENCE ONLY - EXAMPLE

ROOFING TYPE  
SPECIFIED: \_\_\_\_\_

15 LB. VAPOR BARRIER  
ON 1/2" O.S.B. ROOF SHEATHING

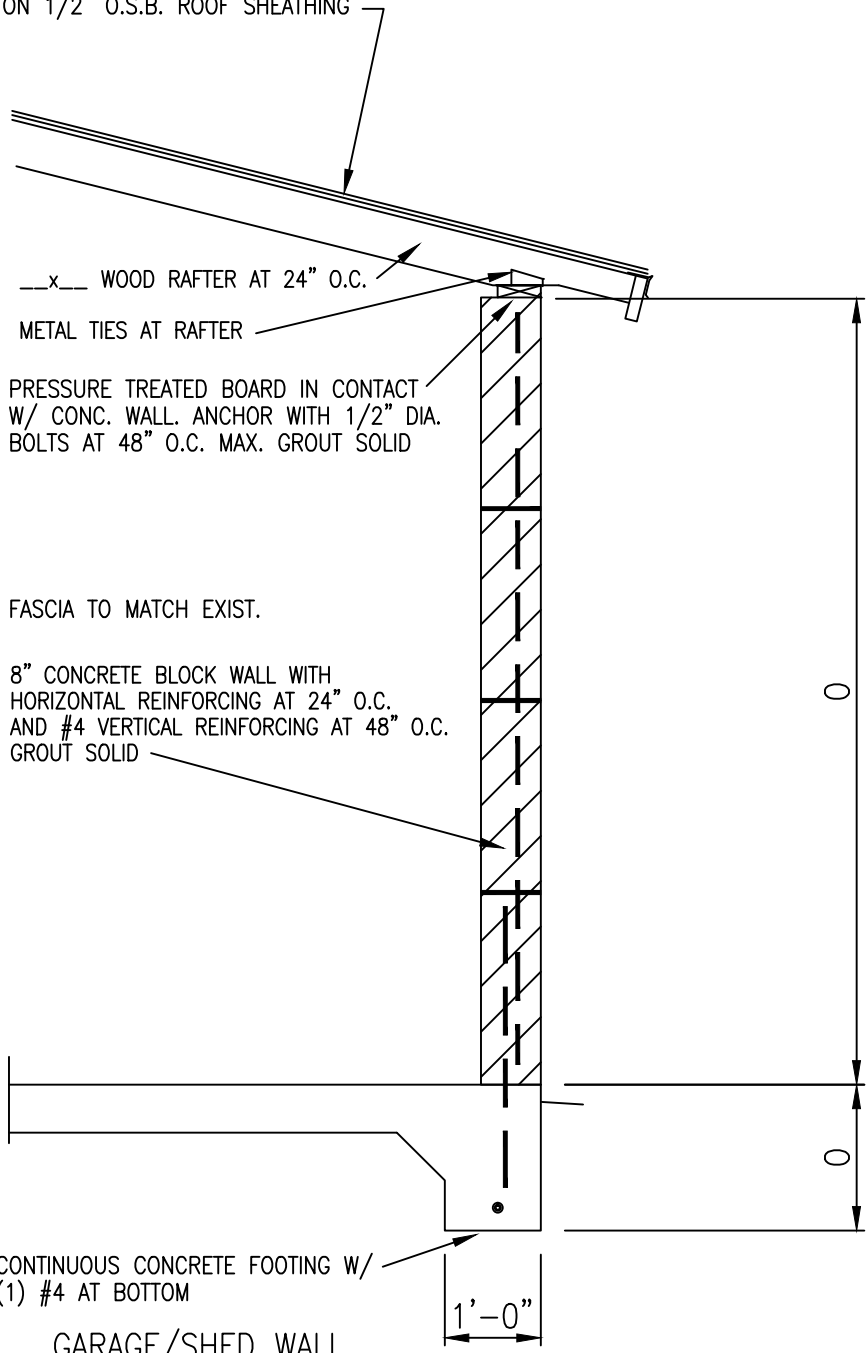

\_\_\_x\_\_\_ WOOD RAFTER AT 24" O.C.

METAL TIES AT RAFTER

PRESSURE TREATED BOARD IN CONTACT  
W/ CONC. WALL. ANCHOR WITH 1/2" DIA.  
BOLTS AT 48" O.C. MAX. GROUT SOLID

FASCIA TO MATCH EXIST.

8" CONCRETE BLOCK WALL WITH  
HORIZONTAL REINFORCING AT 24" O.C.  
AND #4 VERTICAL REINFORCING AT 48" O.C.  
GROUT SOLID

CONTINUOUS CONCRETE FOOTING W/  
(1) #4 AT BOTTOM

GARAGE/SHED WALL

1'-0"

○  
○  
○

PUT DIMENSIONS AT THE CIRCLES

PROPERTY ADDRESS=

CITY OF MESA – FOR REFERENCE ONLY – EXAMPLE