



SOUTHEAST MESA LIBRARY

VIRTUAL PUBLIC MEETING - APRIL 28TH, 2022
CITY OF MESA PROJECT NO. CP0428

PANELISTS

Kevin Thompson – Councilmember District 6

Jesse Simms– Mesa Public Library / Assistant Library Director

Zac Koceja – Engineering Project Manager / Landscape Architect

Curt Albright – Engineering Public Relations Supervisor

Jeremy Kotter – Architect & Project Manager / Richärd Kennedy Architects

WELCOME

Kevin Thompson

Councilmember District 6

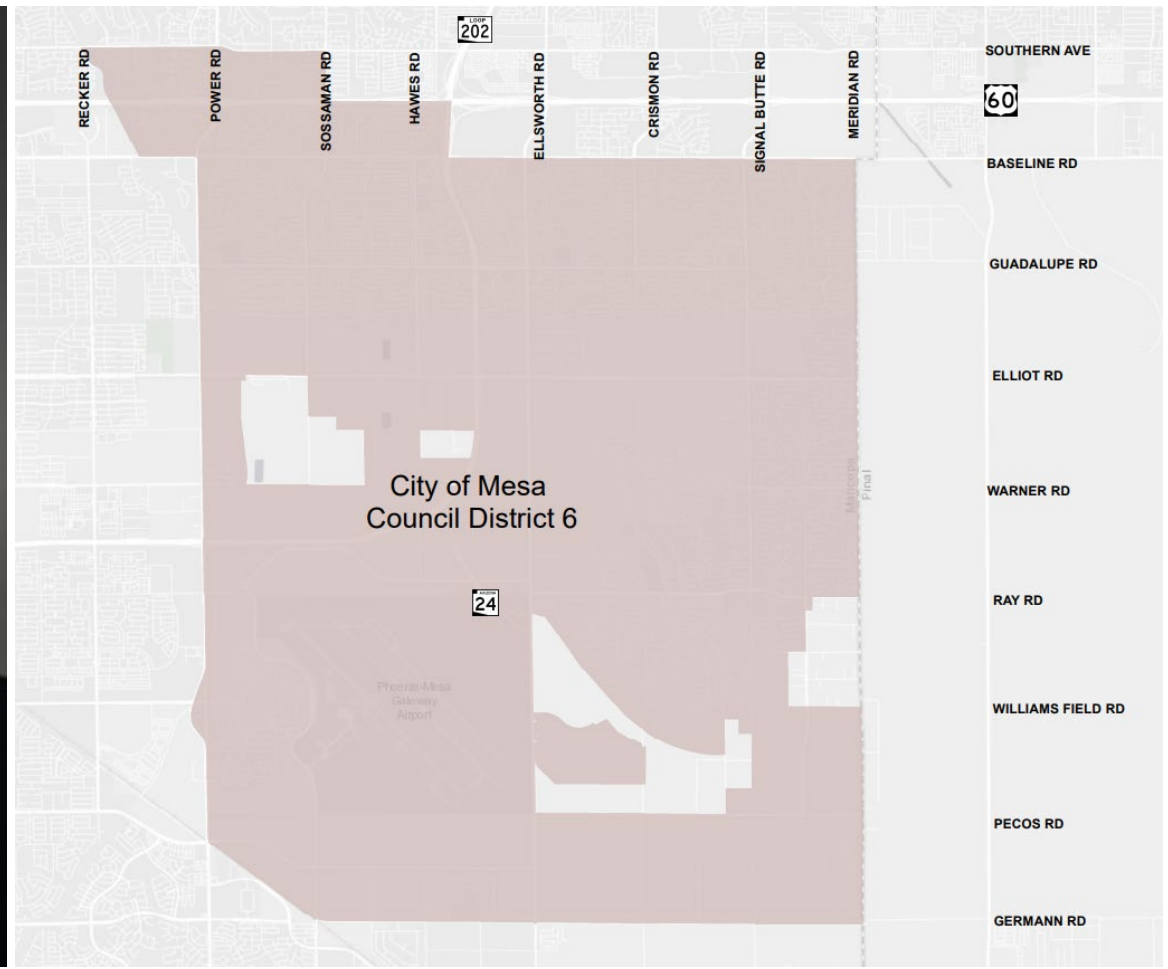

THREE POLL QUESTIONS



Please answer each poll question
when it appears on your screen.

MESA PUBLIC LIBRARY OVERVIEW

Need Identified	2018 Southeast Branch Needs Assessment Report
Scope	New Branch Library
Funding Source	Voter Approved 2018 General Obligation Bond
Size	~30,000 sf
Project Budget	\$16.8M
Design	Spring 2022 – Summer 2023
Construction	Summer 2023 – Opening Summer 2024

**EASTMARK
GREAT PARK**

**KINETIC PARK
HOMES**

**BASIS
MESA**

**INSPIRIAN PARK
HOMES**

**ORANGE MULTI-USE
MONSTER FIELD SITE**

**STEADFAST
FARMS**

LAKE

AMPHITHEATER

**THE RESERVE AT
EASTMARK**

**COMMUNITY
CENTER**

INSPIRIAN PKWY

S EASTMARK PKWY

E RAY RD

LOCATION

*AT ANY TIME DURING THE PRESENTATION YOU CAN USE THE "CHAT" OPTION TO SUBMIT YOUR QUESTIONS & COMMENTS





VIEW OF SITE FROM THE NORTHWEST



VIEW OF SITE FROM THE EAST

EXISTING SITE CONDITION

*AT ANY TIME DURING THE PRESENTATION YOU CAN USE THE "CHAT" OPTION TO SUBMIT YOUR QUESTIONS & COMMENTS





'THE MARK' COMMUNITY CENTER



AMPHITHEATER



WETLANDS RETENTION



LAKE



ORANGE MONSTER



PAVILION

GREAT PARK CONTEXT

*AT ANY TIME DURING THE PRESENTATION YOU CAN USE THE "CHAT" OPTION TO SUBMIT YOUR QUESTIONS & COMMENTS





VISIONING



SPACE PLANNING

needs

TYPOLOGY: **YOUTH SERVICES** ACCESS: OPA

AREA DESCRIPTION: ENTRY/SERVICE DESK

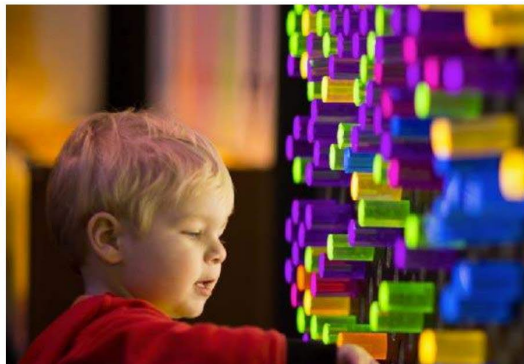

EQUIPMENT LIST

1. Service desk, staffed (1) person
2. Self check
3. Monitor, wall mounted or on stand
4. Task chair

PLAN VIEW

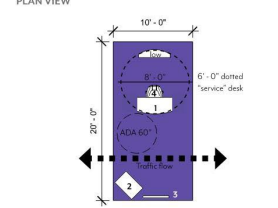

SCALE: 1/8"=1'-0"

ADJACENCY DIAGRAM

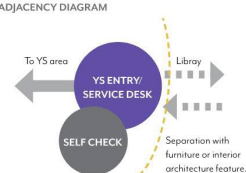

KEY CAPACITY ROOM TYPE NSF SIZE UNIQUE REQUIREMENTS

5.1	*	OPA	200	DYNAMIC SPACE
-----	---	-----	-----	---------------

HOW DO YOU ENVISION THIS SPACE WORKING?

1. Intuitive entry - All will know this is space designated for youth
2. Timeless entry. Do not follow trends.

*Circulation passage to Youth Services

4-76

needs



CHARRETTE

LIGHTING

1. Lighting featured at the entry to reflect youth entrance.
2. Tasklighting at desk.

ACOUSTICS

1. General

AV DATA

2. Wifi
3. Plane for a monitor to exhibit programming.

ELECTRICAL

1. Floor locations to support computer, self check and monitor.

4-77

GOAL SETTING



PROGRAMMING FOCUS GROUPS

*AT ANY TIME DURING THE PRESENTATION YOU CAN USE THE "CHAT" OPTION TO SUBMIT YOUR QUESTIONS & COMMENTS

COMMUNITY

lobby
pre-function
multi-purpose room
meeting room
storage
autism program room

THINKspot

the STUDIO
makerspace equipment
storage
program room

TEEN

ya collection
gaming area
teen lounge
study space

ADULT

adult fiction collection
adult non-fiction collection
media collection
stuffbrary
seed collection
public computers
open seating
collaboration rooms
zoom rooms

LIBRARY SERVICES

service desks & self-check
automated sorting room
holds
copy & print station

CHILDREN'S

service desk
easy readers
family lounge
board books
children's fiction collection
children's non-fiction collection
children's computers
stroller parking
storytime room
storage
children's media

OUTDOOR

reading deck
community garden
staff patio
thinkspot workspace
children's patio

STAFF & VOLUNTEER

staff offices
common work area
staff kitchen
staff lounge
storage
staff program room
sales & display

BLDG SERVICE

restrooms
janitor
mechanical
electrical
telecom / av
storage

PROGRAM

*AT ANY TIME DURING THE PRESENTATION YOU CAN USE THE "CHAT" OPTION TO SUBMIT YOUR QUESTIONS & COMMENTS



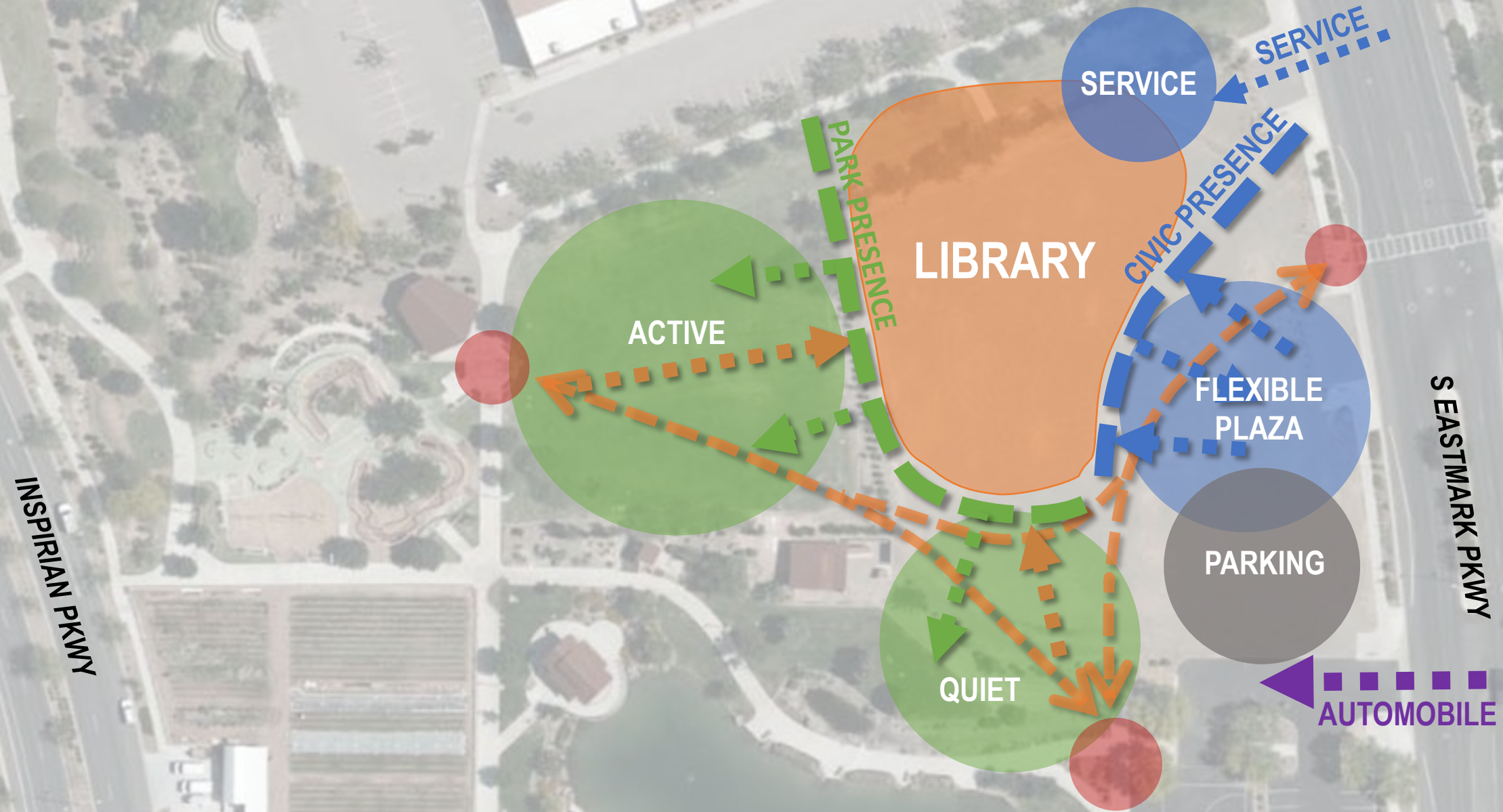

CONNECTIVITY

*AT ANY TIME DURING THE PRESENTATION YOU CAN USE THE "CHAT" OPTION TO SUBMIT YOUR QUESTIONS & COMMENTS





MARKET EXTERIOR

*AT ANY TIME DURING THE PRESENTATION YOU CAN USE THE "CHAT" OPTION TO SUBMIT YOUR QUESTIONS & COMMENTS



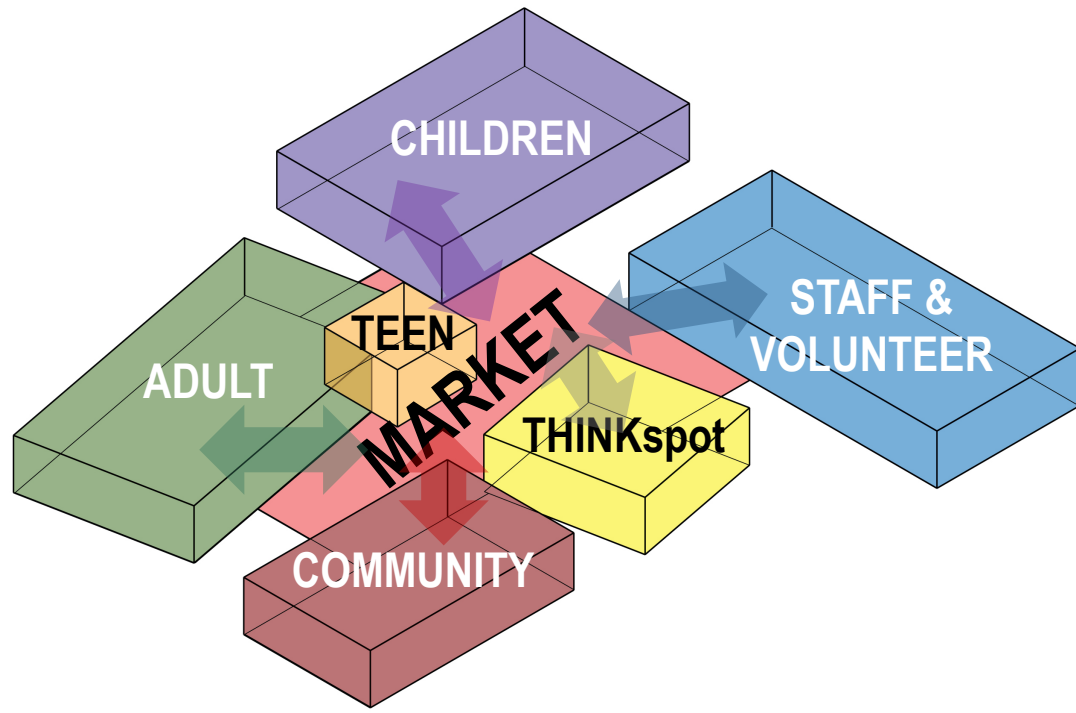

MARKET INTERIOR

*AT ANY TIME DURING THE PRESENTATION YOU CAN USE THE "CHAT" OPTION TO SUBMIT YOUR QUESTIONS & COMMENTS



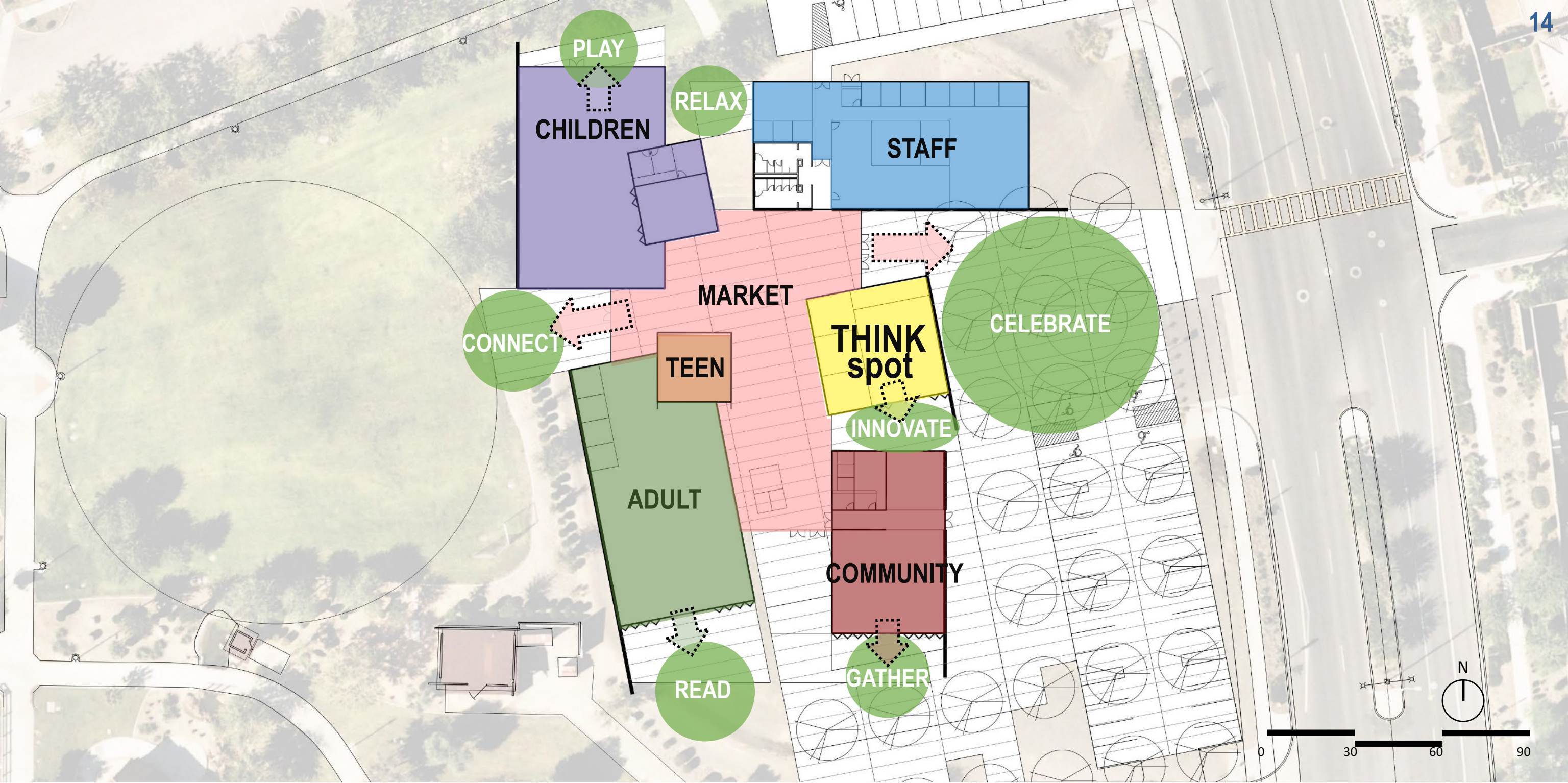

OUTDOOR PROGRAMS

*AT ANY TIME DURING THE PRESENTATION YOU CAN USE THE "CHAT" OPTION TO SUBMIT YOUR QUESTIONS & COMMENTS



**EASTMARK
GREAT PARK**

BASIS MESA

**ORANGE
MONSTER**

**KINETIC PARK
HOMES**

**INSPIRIAN PARK
HOMES**

**STEADFAST
FARMS**

THE LAKE

AMPHITHEATER

INSPIRIAN PKWY

S EASTMARK PKWY

**COMMUNITY
CENTER**

CONCEPTUAL SITE PLAN

*AT ANY TIME DURING THE PRESENTATION YOU CAN USE THE "CHAT" OPTION TO SUBMIT YOUR QUESTIONS & COMMENTS



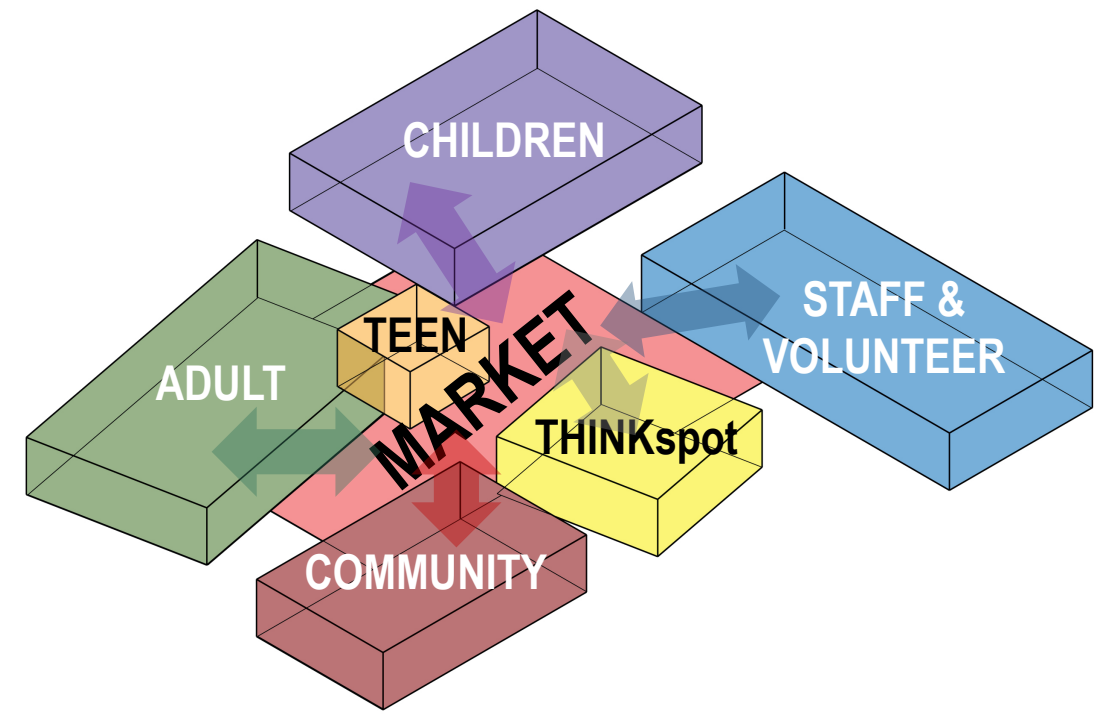
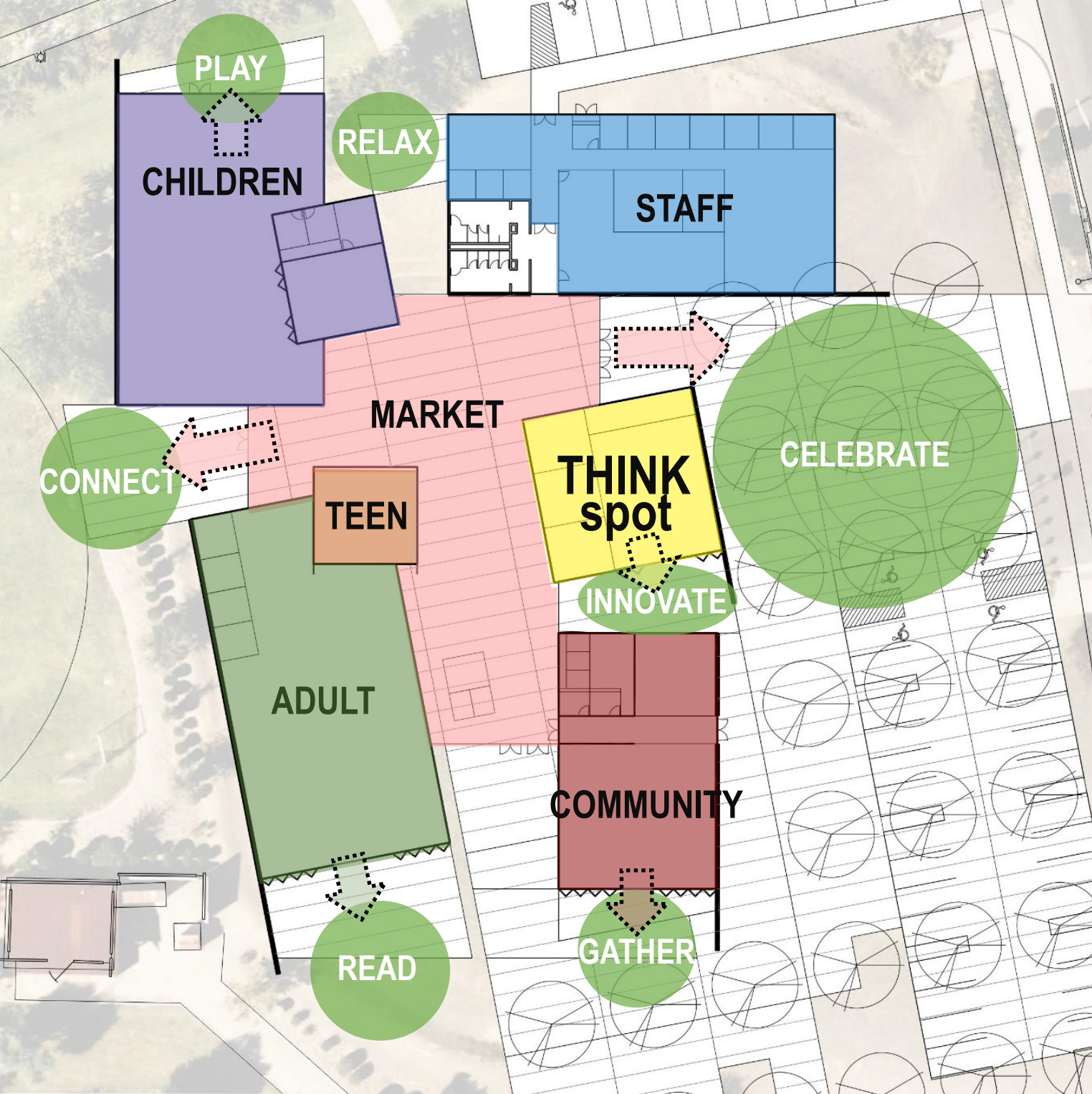

CONCEPTUAL APPROACH



FEEDBACK : Q+A

It's time to hear from you. Please submit comments and questions by using the chat window on your screen to enter questions or comments. The panel will then read them aloud and respond.

Ground Rules:

1. Please keep questions/comments relevant and specific to this project.
2. Please keep questions/comments/concerns as specific as possible.
3. Please do not use inflammatory language in your comments.

CLOSING REMARKS: SURVEY

Thank you for participating in this design process and providing your feedback. If you have additional comments regarding the items presented, you can contact us the following ways:

1. Add your comments in the **survey** that will pop up when you exit the meeting. The survey will also be e-mailed to you if you wish to answer it later.
2. Email us directly at Engineering.Info@MesaAZ.gov – please reference “Southeast Mesa Library” in the subject line.
3. Contact Curt Albright with the City of Mesa, Engineering Public Relations group at 480-644-3800.

The deadline for comments is May 12th, 2022

Stay tuned for future notifications & invitations for a follow-up public meeting for the project.